



intAct Traktion-Power

Low-maintenance lead-acid battery with reinforced grid plates

Art.No.

95803GUG

Volt	12V
Capacity	80 AH (c5)
CCR -18°C (EN)	-
Electrolyte	diluted sulphuric acid
Electrolyte density	1,28 +/- 0,01 Kg/l (25° C)
Size (LxWxH)	353 x 175 x 190 mm
Weight	22,5 kg
Pos. of Terminal	0
Terminal	1
Base plate	B13

Usage



Proven and cost-conscious

Due to their excellent high-current characteristics, they are particularly suitable for propelling golf carts, small leisure vehicles, wheelchairs, mobile lifting platforms, cleaning machines and forklifts. Our recommendation, for all who are looking for an inexpensive traction battery and are not afraid of maintenance.

- » **2 versions:** Wet charged (GUG) or dry-charged (TV).
- » **Light cyclic use:** 300 cycles according to IEC 254-1.
- » **Reinforced special-insulation grid plates** with high mass utilisation for maximum capacity reserves.
- » **6-volt and 12-volt versions.**
- » **Optional water filling system** can be attached to extend service intervals.
- » **Flooded lead-acid battery. Low maintenance.**

Size

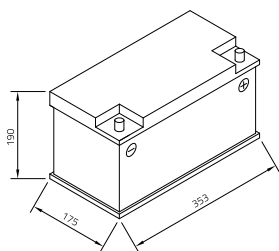

Pos. of Terminal 0

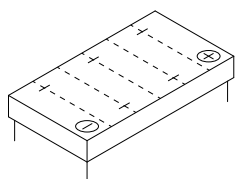

Terminal 1

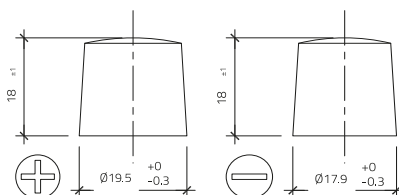

Base plate B13

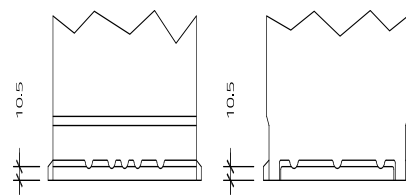

As of 04.05.2023